

# Island Accessories

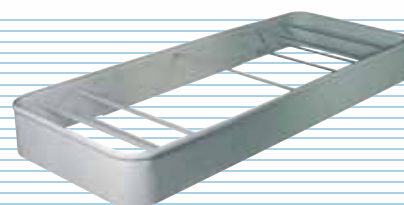

- Spring Balance Hose Retractors ..... 254 - 257
- Counterweight Hose Retractors..... 258 - 259
- Standard Island Forms.....260 - 261
- Build Your Own Island Forms & Protective Curbing.....262 - 263
- Pipe Guards ..... 264

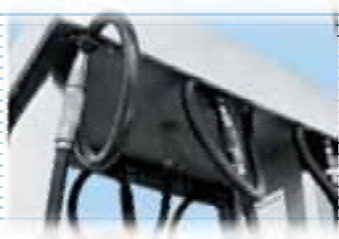

Setting the industry standard in retail and commercial fueling solutions worldwide since 1892.

## POMECO 102 Spring Balance Single Hose Retractors

POMECO 102 Spring Balance Single Hose Retractors keep excess hose off the ground and out of the way, prolonging hose life and reducing potential hazards. The POMECO 102 is a California Air Resources Board (CARB) certified Stage II component for use with single and dual hose dispensers as per Executive Order G-70-52-AM.



Post Mounted

### Materials

- Housing:** Cast aluminum
- Cable:** Black polyester
- Post:** Aluminum



**Nozzle, Hook and Hood Kit Not Sold by OPW.**

### Features

- ◆ **Easy to Use** – the spring-loaded reel and stretch-resistant cable provide smooth and steady tension throughout hose extension and return.
- ◆ **Easy to maintain** – the removable sideplate provides full access to the mechanism for easy tension adjustment and unit maintenance. A convenient safety thumb screw is provided to lock the reel in place during tension adjustment.
- ◆ **Field Adjustable for Various Hose, Nozzle, Swivel, Breakaway Combinations** – no need for upgrading components if a breakaway or swivel is added to the hose assembly. Simply change the tension setting on the spring-loaded hose reel.
- ◆ **Multiple Mounting Options** – the POMECO 102 retractor housing is tapped on the top for bolting to overhead crossbars, and on the side for mounting to vertical posts. The 102 is available as a retractor kit (including post, retractor and mounting hardware) or as separate components. Models are also available for aboveground storage tank (AST) applications. AST models include a 44" (112 cm) post with a freestanding base.

102 Spring Balance Hose Retractor  
Instruction Sheet Order Number:  
**H15853PA**

## Ordering Specifications

### Vertical Retractor Kits (Box, Post, Bracket, Foot & Hardware)

Model Number	Mounting Method	Clamp Fits				Weight	
		Hose O.D.		Hose I.D.		lbs.	kg
		in.	mm	in.	mm		
6102-1039P	39" Retractor/Post Kit	(Hose Clamp Not Included)				12	5.4
6102-1078P	78" Retractor/Post Kit	(Hose Clamp Not Included)				14	6.4
6102-AST	AST	(Hose Clamp Not Included)				9	4.1

## Ordering Specifications

### Separate Retractor Components (Box Only)

Model Number	Mounting Method	Clamp Fits				Weight	
		Hose O.D.		Hose I.D.		lbs.	kg
		in.	mm	in.	mm		
6102-1000	Overhead Crossbar/Verticle Post	(Hose Clamp Not Included)				7	3.2
6102-4000	Overhead Crossbar/Verticle Post	1 1/8"	35	1"	25	7	3.2
6102-6000	Overhead Crossbar	1 1/2"	26	5/8" or 3/4"	16 or 19	7	3.2
6102-8000	Overhead Crossbar	1"	25	5/8"	16	7	3.2

\*POMECO recommends using C05238M, C05261M or P100-3F/P100-44/P100-2AST for use with 102 Series retractors. Other size tubes and clamps available upon request.



Hose Clamp

## Ordering Specifications

### Hose Clamps

Model Number	Hose Clamp Size†
PB-1396	Standard 1 1/8" O.D. Hose (1" I.D.)
PB-1394	Standard 1 1/8" O.D. Hose (3/4" I.D.)
PB-1375	Standard 1 1/2" O.D. Hose (5/8" or 3/4" I.D.)
PB-1373	Standard 1" O.D. Hose (5/8" I.D.)
PB-1344	Balanced Coaxial, Goodyear Premier
PB-1340	Balanced Coaxial, Dayco Petroflex

† Other sizes available upon request

### Options Replacement Parts

Model Number	Hose Clamp Size
C05238M	Post Kit, 39"(99 cm), 1 1/8" x 2"
C05261M	Post Kit, 78"(198 cm), 1 1/8" x 2"
H15212M	12' Replacement Cable
P338SPOOL	338' Spool of Retractor Cable
P100SPOOL	1000' Spool of Retractor Cable
H15210M (P102-02)	Replacement Cable Guide
H15211M	Replacement Reel
P100-3F	AST Replacement Base
P100-2AST	Sliding Bracket (AST)

## POMECO 102 Spring Balance MPD Hose Retractor Packages

POMECO 102 Spring Balance MPD Hose Retractors keep excess hose off the ground and out of the way, prolonging hose life and preventing extra length hoses from cluttering the island. The 102 MPD hose retractors are especially well-suited for use on Multiple Product Dispensers (MPD) with Stage II Vapor Recovery hose/nozzle assemblies. The POMECO 102 is a California Air Resources Board (CARB) certified Stage II component for use with MPDs as per Executive Order G-70-52-AM.



### Materials

- Housing:** Cast aluminum
- Cable:** Black polyester
- Bracket:** Steel



### Features

- ◆ **Easy to Install** – each model number designates a custom designed retractor package that mounts in the canopy of a particular manufacturer's MPD. Packages are shipped complete with the appropriate number of retractors and all the necessary mounting hardware for a clean, professional installation.
- ◆ **Easy to Use** – the spring-loaded reels and stretch-resistant cables provide smooth and steady tension throughout hose extension and return.
- ◆ **Easy to Maintain** – the removable sideplate provides full access to the mechanism for easy tension adjustment and unit maintenance. A convenient safety thumb screw is provided on each retractor to lock the reel in place during tension adjustment.



## Ordering Specifications

Model Number	Manufacturer/Dispenser	Hoses Per Side***	Weight	
			lbs.	kg
6102-DW1037	Dresser Wayne (37" Frame)	1	40	18.2
6102-DW1048	Dresser Wayne (48" Frame)	1	50	22.7
6102-DW2037	Dresser Wayne (37" Frame)	2	50	22.7
6102-DW2048	Dresser Wayne (48" Frame)	2	58	26.3
6102-DW3048	Dresser Wayne (48" Frame)	3	72	32.6
6102-GB1N	Gilbarco (Advantage Narrow)	1	46	20.9
6102-GB2N	Gilbarco (Advantage Narrow)	2	60	27.2
6102-GB1W	Gilbarco (Advantage Wide)	1	50	22.7
6102-GB2W	Gilbarco (Advantage Wide)	2	63	28.6
6102-GB3W	Gilbarco (Advantage Wide)	3	77	34.9
6102-GB30	Gilbarco MPD	3	77	34.9
6102-EC01	Gilbarco (Encore)	1	77	34.9
6102-EC02	Gilbarco (Encore)	2	77	34.9
6102-TK10	Tokheim 320 Series	1	40	18.2
6102-TK20	Tokheim 320 Series	2	58	26.3
6102-TK1424	Tokheim 424C Series	1	40	18.2
6102-TK3426	Tokheim 426 Series	3	72	32.6

\*Specify dispenser model and serial number when ordering  
\*\*\* Hose clamps must be ordered separately for MPD models

NOTE: All 6102 MPDs come with two brackets and the number of hose retractors per side.



Hose Clamp

## Ordering Specifications

### Hose Clamps

Model Number	Hose Clamp Size†
PB-1396	Standard 1 1/8" O.D. Hose (1" I.D.)
PB-1394	Standard 1 1/8" O.D. Hose (3/4" I.D.)
PB-1375	Standard 1 1/2" O.D. Hose (5/8" or 3/4" I.D.)
PB-1373	Standard 1" O.D. Hose (5/8" I.D.)
PB-1344	Balanced Coaxial, Goodyear Premier
PB-1340	Balanced Coaxial, Dayco Petroflex

† Other sizes available upon request

### Options Replacement Parts

Model Number	Hose Clamp Size
H15210M	Replacement Cable Guide
H15212M	Replacement Cable -12 ft.
H15211M	Replacement Reel
D02147M	Replacement Housing
H15265M (P102-2)	Sliding Bracket
C05239M	Foot (Bottom)
D02628M	Bracket Only for 06102-DW3
D02629M	Bracket Only for 06102-DW4

## POMEKO 100 Counterweight Hose Retractors

POMEKO 100 Counterweight Hose Retractors keep excess hose off the ground and out of the way, prolonging hose life and reducing potential hazards. The POMEKO 100 is a California Air Resources Board (CARB) certified Stage II component for use with single and dual hose dispensers as per Executive Order G-70-52-AM.



### Materials

- Housing:** Impact-resistant plastic
- Cable:** Black polyester
- Post:** Aluminum (2"x 2")

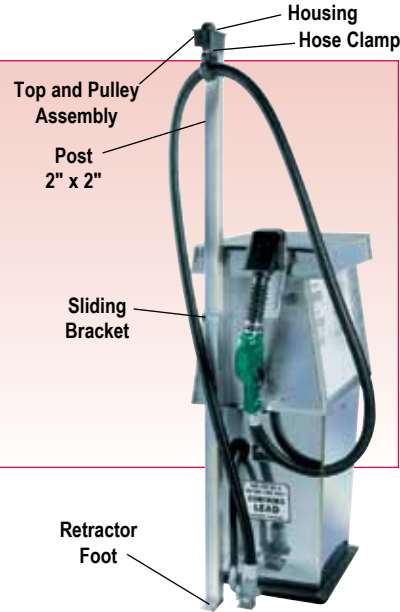

### Features

- ◆ **Easy to Use** – counterweights are precisely matched to each hose configuration to ensure that a minimal pulling force is needed throughout hose extension.
- ◆ **Easy to Maintain** – the 100 has just two moving parts, ensuring a long service life with a minimum of maintenance.
- ◆ **Multiple Hose Configurations** – the 100 is available in a multitude of configurations to meet virtually any conventional or vapor recovery hose/nozzle configuration. Models are also available for air and water hose applications to keep hoses clear of vehicles when not in use.

## Ordering Specifications

### Conventional and Vapor Recovery Applications

Model Number*	Hose Configuration	Clamp Fits						Height		Weight	
		Hose Length		Hose O.D.		Hose I.D.					
		ft.	meters	in.	mm	in.	mm	in.	cm	lbs.	kg
6100-4000	Conventional	12-14'	3.7-4.3	1½"	35	1"	25	79"	201	33	15.0
6100-5000	Conventional	15-18'	4.6-5.5	1½"	35	1"	25	92"	234	38	17.2
6100-6000	Conventional	12-14'	3.7-4.3	1½"	26	⅝" or ¾"	16 or 19	79"	201	30	13.6
6100-7000	Conventional	15-20'	4.6-6.1	1½"	26	⅝" or ¾"	16 or 19	92"	234	31	14.1
6100-8000	Conventional	12-14'	3.7-4.3	1"	25	⅝"	16	79"	201	29	13.2
6100-9000	Conventional	15-20'	4.6-6.1	1"	25	⅝"	16	92"	234	30	13.6
6100-AGNV	Inverted Coaxial	11-13'	3.4-4.0	(Hose Clamp Not Included)			79"	201	33	15.0	
6100-AGLC	Coaxial	11-13'	3.4-4.0	(Hose Clamp Not Included)			79"	201	26	11.8	
6100-AGBR	Coaxial w/Breakaway	11-13'	3.4-4.0	(Hose Clamp Not Included)			79"	201	31	14.1	

\*Add a "P" to the end of model number for black epoxy coated mounting post. EXAMPLE: 6100-4000P

100 Series Counterweight Hose Retractor Instruction Sheet Order Number: **H15852PA**



NOTE: See OPW's Website at [www.opwglobal.com](http://www.opwglobal.com) for product instruction sheets, trouble shooting guides, how-to-use guide and to view the Do's & Don'ts at the Gas Pump video.

## Options and Replacement Parts

Part #	Description	Counterweight Length		Weight	
		in.	cm	lbs.	kg
H15262	Counterweight for 4000/AGNV Models	27"	68.5	24	10.8
H15263	Counterweight for 5000 Model	31"	78.7	27	12.2
H15260	Counterweight for 6000 Model	20"	50.8	17	7.7
H15261	Counterweight for 7000, 8000, 9000, AGRB Models	25"	63.5	22	9.9
H15265M	Sliding Bracket, Dispenser Mount				
P100-HL	Highline Mounting Bracket				
C05235M	Replacement Tube, 2"x 2"x 75" (191 cm)				
C05236M	Replacement Tube, 2"x 2"x 88" (224 cm)				
C05237M	Replacement Tube, 2"x 2"x 120" (305 cm)				
D02671M	Replacement Housing, Plastic				
H15266	Top and Pulley Assembly				
H15264	Replacement Cable				
C05239M	Retractor Foot				
P100-3F	Freestanding Retractor Base				
P100SPOOL	Replacement Cable Spool, 1000'				
P100-AL	Aluminum Housing				
H15266	Plastic Top & Pulley Assembly				

## Ordering Specifications

### Hose Clamps

Model Number	Hose Size/Type†
PB-1396	Standard 1½" O.D. Hose (1" I.D.)
PB-1394	Standard 1½" O.D. Hose (¾" I.D.)
PB-1375	Standard 1½" O.D. Hose (⅝" or ¾" I.D.)
PB-1373	Standard 1" O.D. Hose (⅝" I.D.)
PB-1344	Balanced Coaxial, Goodyear Premier
PB-1340	Balanced Coaxial, Dayco Petroflex



Hose Clamp

† Other sizes available upon request

## Ordering Specifications

### Air/Water Hose Applications

Model Number	Description	S Hose Length		Height		Weight	
		ft.	meters	in.	cm	lbs.	kg
6100-DAWO	Air/Water Hose Retractor (complete with dual hose)	18.5'	5.6	124"	315	26	11.8
6100-DAOO	Air Hose Retractor (complete with air hose)	18.5'	5.6	124"	315	23	10.4
6100-DANC	Air Hose Retractor (with hose clamp only)			124"	315	20	9.1
6100-DANH	Air Hose Retractor (no hose or clamp)			124"	315	20	9.1

## POMEKO 100 Counterweight T-Top Retractors

The T-Top Air/Water model separates the hoses allowing one hose to be used while the other remains safely out of the way.



OPW is the world leader in commercial and industrial protective curbing products. The company designs, engineers and manufactures island forms, curb fascia, pipe and bumper guards to meet virtually any protective curbing application.

### POMECO/OPW Island Forms Feature:

- ◆ **Variety of End Sections, Lengths, Widths and Styles** - allows for a customized fit to site constraints and requirements.
- ◆ **Spacious Mid-Section** - provides ample room to install standard and wide-access dispenser sumps from the top of the island.
- ◆ **Unique Sump Mounting System** - ensures the dispenser sump is anchored to the Island Form and adjustable to accommodate various width sumps.
- ◆ **Convenient Shipping and Storage** - revolutionary threaded-stud bracing system allows forms to stack together and enables boxing of the island assembly.
- ◆ **Easy Installation** - cross braces bolt onto threaded studs. Field welding is not required.
- ◆ **Attractive Appearance** - link plates impart a crisp, clean exterior joint between sections for a smooth, finished presentation.

## POMECO/OPW Island Forms and Protective Curbing

Designed to protect gasoline dispensers, electronic equipment, kiosks, bank teller and ATM equipment, as well as to restrict or route material handling equipment in warehouses, OPW Island Forms and Protective Curbing streamline traffic flows in toll booths and quick-serve restaurants and various other commercial traffic management applications.



## POMECO/OPW Standard Island Forms

Specify Standard Island Form configurations designed by OPW for a wide variety of retail, commercial and industrial traffic management applications.

### Hour Glass Island Forms

Hour Glass Island Forms are designed with side sections integrating a double-reverse 9" taper to provide easy access to multi-product gasoline dispensers while protecting expensive electronic equipment. Ends of these islands can be extended to wrap around canopy columns, hose bibs or trash receptacles by simply adding straight sections.

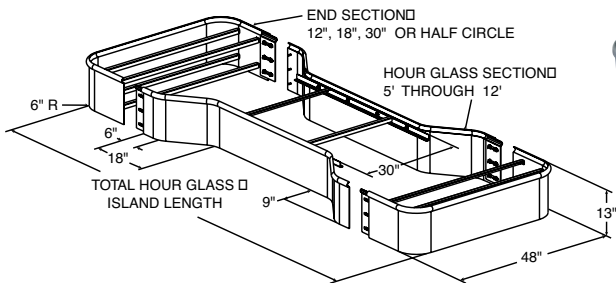

### Hour Glass Island Form Specification/Ordering Guide

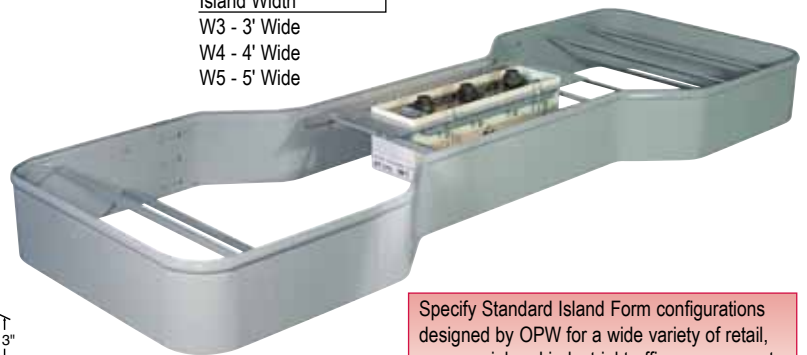
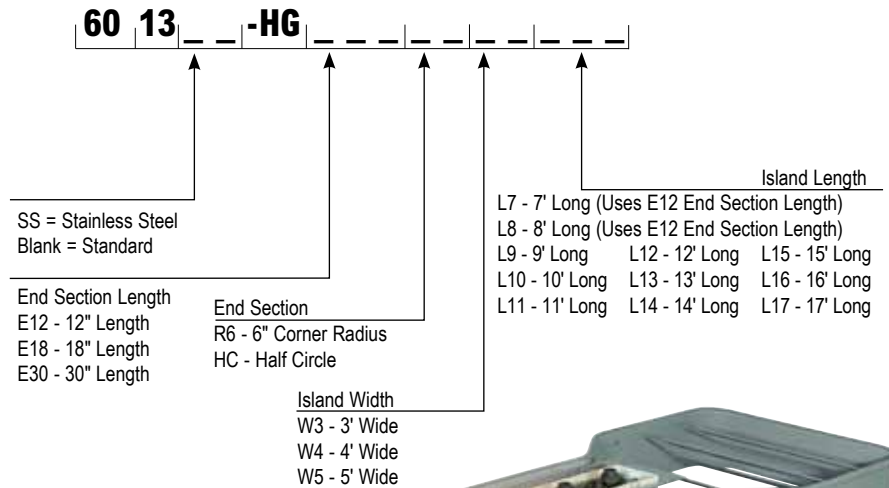

Specify Standard Island Form configurations designed by OPW for a wide variety of retail, commercial and industrial traffic management applications.

### Standard (Straight) Island Forms

Straight Island Forms are designed with straight side sections to provide a convenient means of installing multiple dispensers on a single island. Straight Island Forms are also used to protect teller and ATM equipment at banks, restrict or route material handling equipment in warehouses, streamline traffic flows in toll booths and quick-serve restaurants and various other commercial traffic routing applications.

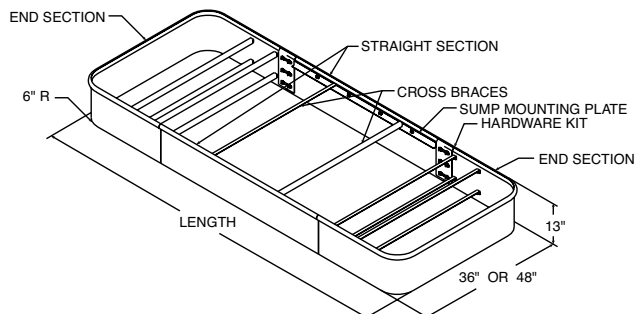

### Standard (Straight) Island Form Specification/Ordering Guide

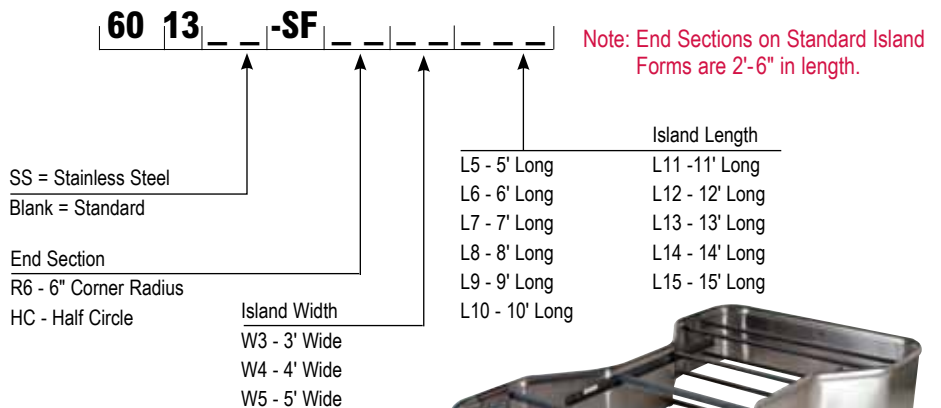

For Custom Island Forms,  
Contact OPW Customer Service 1-800-422-2525

## Build Your Own Island Form Or Curbing From Individual Sections

Build your own Island Forms and Protective Curbing to fit your particular application from standard sections.

### Standard Island Form End Sections

End Sections are available to build customized Island Forms from standard POMECO Island Form components. Sections are available in Half Circle or 6" Radius configurations. Each End Section is pre-braced and includes all required hardware for assembly.

### Ordering Specifications (Standard End Sections)

Model #	Radius (in.)	Width (ft)	Length	Weight
6013P-EHCW3L30	Half Circle	3	2' 6"	37 lbs.
6013P-EHCW4L30	Half Circle	4	2' 6"	40 lbs.
6013P-ER6W3L18	6	3	1' 6"	37 lbs.
6013P-ER6W3L30	6	3	2' 6"	45 lbs.
6013P-ER6W4L12	6	4	1'	35 lbs.
6013P-ER6W4L18	6	4	1' 6"	40 lbs.
6013P-ER6W4L30	6	4	2' 6"	52 lbs.

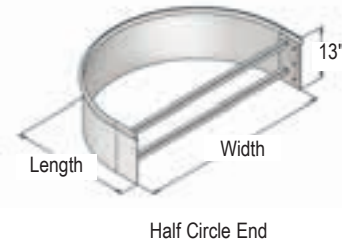
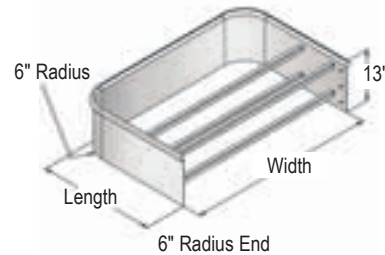

### Bumper Guard End Sections

Bumper Guard End Sections replace Standard End Sections on Island Forms to provide additional protection for gasoline dispensers or other critical components. A protective bumper and internal bracing are welded to a standard End Section, allowing concrete to be poured in the form above the finished island grade.

### Ordering Specifications (Bumper Guard End Sections)

Model No.	Section Length	Radius (in.)	Width (ft.)	Bumper Length	Bumper Height (in.)
6013-BGHCW3L15H12	2' 6"	Half Circle	3	1' 6"	12
6013-BGHCW3L15H18	2' 6"	Half Circle	3	1' 6"	18
6013-BGHCW4L20H12	2' 6"	Half Circle	4	2'	12
6013-BGHCW4L20H18	2' 6"	Half Circle	4	2'	18
6013-BGR6W3L25H12	2' 6"	6	3	1'	12
6013-BGR6W3L25H18	2' 6"	6	3	1'	18
6013-BGR6W4L12H12	1'	6	4	1'	12
6013-BGR6W4L18H12	1' 6"	6	4	1'	12
6013-BGR6W4L25H12	2' 6"	6	4	1'	12
6013-BGR6W4L12H18	1'	6	4	1'	18
6013-BGR6W4L18H18	1' 6"	6	4	1'	18
6013-BGR6W4L25H18	2' 6"	6	4	1'	18

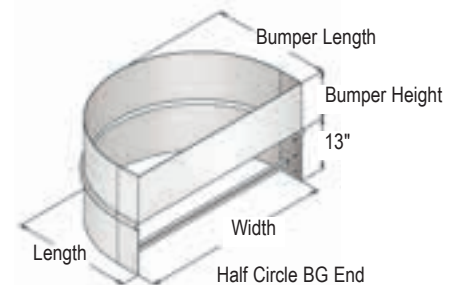
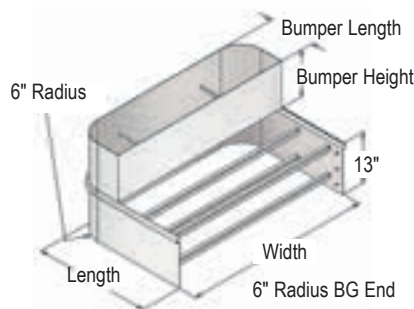

### Hour Glass Sections

Hour Glass Sections are designed with double-reverse 9" tapers to provide easy access to multi-product gasoline dispensers. One-piece Hour Glass Sections are available from 5' through 9'. Sump Support Bars are included with individual Hour Glass Sections. HGL and HGR sections can be used in conjunction with Straight Sections when designing longer Hour Glass Islands, or for use in Protective Curbing applications.

### Ordering Specifications (Hour Glass)

Model No.	Length	Comments	Wgt (lbs.)
6013P-HGL	2'	Hour Glass Left Side Section	13
6013P-HGR	2'	Hour Glass Right Side Section	13
6013P-HG05	5'	Hour Glass Side Section	35
6013P-HG06	6'	Hour Glass Side Section	40
6013P-HG07	7'	Hour Glass Side Section	45
6013P-HG08	8'	Hour Glass Side Section	50
6013P-HG09	9'	Hour Glass Side Section	56
6013P-HG10	10'	Hour Glass Side Section	62
6013P-HG11	11'	Hour Glass Side Section	68
6013P-HG12	12'	Hour Glass Side Section	74

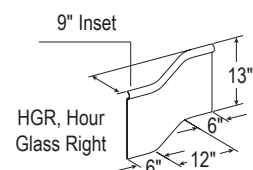
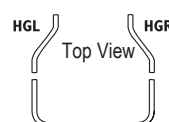
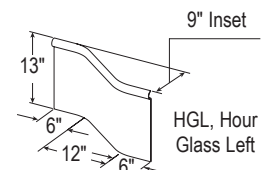
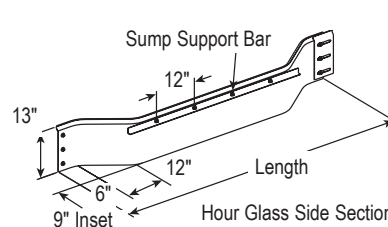

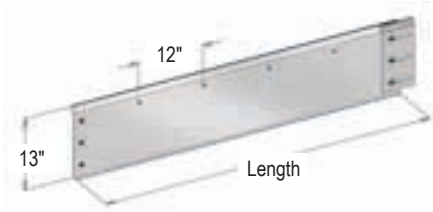

### Straight Sections

Straight Sections are designed with a 1" bottom flange to add rigidity for accurate alignment of sections. Island Form End Sections are easily extended with various-length Straight Sections. Sump Support Bars are not included with individual Straight Sections. Straight Sections are key to the design of Protective Curbing.

#### Ordering Specifications

Model #	Length	Weight
6013P-S01	1'	6 lbs.
6013P-S015	1' 6"	9 lbs.
6013P-S02	2'	12 lbs.
6013P-S025	2' 6"	15 lbs.
6013P-S03	3'	18 lbs.
6013P-S035	3' 6"	21 lbs.
6013P-S04	4'	24 lbs.
6013P-S05	5'	30 lbs.
6013P-S06	6'	36 lbs.
6013P-S07	7'	42 lbs.
6013P-S08	8'	48 lbs.
6013P-S09	9'	54 lbs.
6013P-S10	10'	60 lbs.

C04651M 13" Mounting Plate (Includes Hardware)

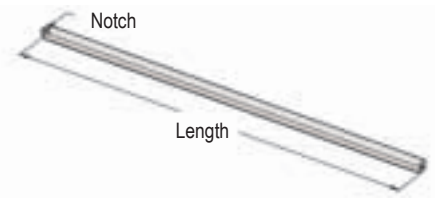

### Cross Braces

Cross Braces are notched on both ends for use with Sump Support Bars. Holes punched in both ends slide over threaded studs to bolt the brace to the island. Bracing is recommended every 2 feet along the inside of Hour Glass and Straight Sections.

#### Ordering Specifications

Model No.	Length (in.)	Weight
6000P-B24	24	1 lbs.
6000P-B30	30	2 lbs.
6000P-B36	36	2 lbs.
6000P-B42	42	2 lbs.
6000P-B48	48	3 lbs.
6000P-B60	60	3 lbs.

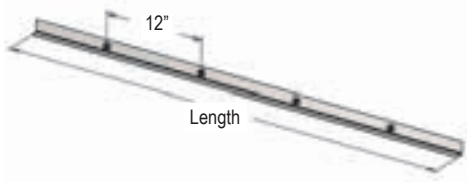

### Sump Support Bars

Sump Support Bars are designed to allow POMECO Island Forms to accept various-width sumps. The bars are positioned to locate the top of OPW Dispenser Sump Frames 1/2" above finished island grade to direct water drainage away from the sump. Sump Support Bars must be specified when designing Island Forms from individual Straight Sections.

#### Ordering Specifications

Model #	Length (in.)	Weight
6000P-SMP	54	3 lbs.

## Build Your Own Island Form Or Curbing

Build your own Island Forms and Protective Curbing to fit your particular application from standard sections.

### Corner Sections

Corner Sections are designed for use in various Island Form widths, or for use in Protective Curbing applications.

#### Ordering Specifications

Model No.	Length (in.)	Weight
6013P-R6C	12	10 lbs.

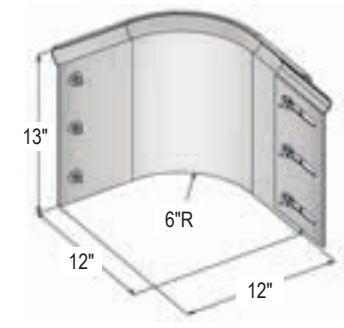

### Curb Fascia Brackets

Curb Fascia Brackets replace cross braces and are designed to brace sections when utilized as protective curb fascia. The brackets are hole-punched for bolting to threaded studs, and allow for 1/2" diameter #4 reinforcement bars to secure the sections in place.

#### Ordering Specifications

Model #	Length (in.)	Weight
6000P-CFB	11	1 lbs.

## OPW Pipe Guards

Pipe Guards help protect gasoline dispensers, light poles and other equipment or property from damage.

### Features:

- ◆ Choice of Styles - POMEKO/OPW Pipe Guards are available in straight, half circle and double radius bends.
- ◆ Variety of Sizes Available - 28", 36", 40" and 48" widths for mounting inside or outside of island forms.
- ◆ Various Lengths Available - for deeper, more secure anchors in islands and concrete slabs.
- ◆ Sturdy Construction - POMEKO/OPW Pipe Guards are manufactured from 4" O.D. and 3.5" O.D. schedule 40 steel pipe.
- ◆ Aesthetically-Pleasing Appearance - POMEKO/OPW Pipe Guards are primer-finished.



### Ordering Specifications

#### Double Radius Pipe Guards

Model No.	Material	Units (inches)			
		A	B	C	D
6PGR3-4153	Steel	41	53	3.50	14.0
6PGR3-4162	Steel	41	62	3.50	14.0
6PGR3-4850	Steel	48	50"	3.50	15.75
6PGR3-4859	Steel	48	59	3.50	15.75
6PGR3SS-3672	Stainless	36	72	3.50	14.00
6PGR3SS-4350	Stainless	43	50	3.50	19.5
6PGR3SS-4850	Stainless	48	50	3.50	19.5
6PGR3SS-5445	Stainless	54	45	3.50	19.5
6PGR4-4153	Steel	41	53	4.0	14.0
6PGR4-4174	Steel	41	74	4.0	14.0
6PGR4-4951	Steel	49	51	4.0	16.0
6PGR4-4972	Steel	49	72	4.0	16.0

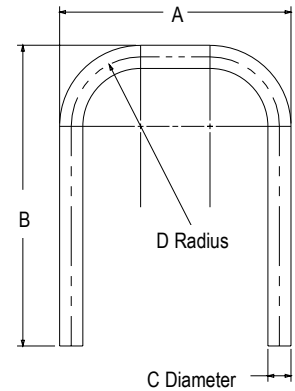

Double Radius Pipe Guards

### Ordering Specifications

#### Straight Pipe Guards

Model #	Units (inches)	
	A	B
SPG4-48	4	48
SPG4-72	4	72
SPG4SS-50 (Stainless)	4	50
SPG6-72	6	72
SPG8-72	8	72
SPG8-96	8	96

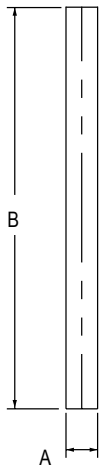

Straight Pipe Guards

### Ordering Specifications

#### Half Circle Pipe Guards

Model #	Material	Units (inches)			
		A	B	C	D
6PGU3-3656	Steel	36	56	3.50	16.25
6PGU3-3666	Steel	36	66	3.50	16.25
6PGU3-4254	Steel	42	54	3.50	16.25
6PGU3-4263	Steel	42	63	3.50	16.25
6PGU3SS-3653	Stainless	36	53	3.50	16.25
6PGU3SS-3656	Stainless	36	56	3.50	16.25
6PGU3SS-4354	Stainless	43	54	3.50	19.50
6PGU4-3656	Steel	36	56	4.0	16.0
6PGU4-3677	Steel	36	77	4.0	16.0
6PGU4-4354	Steel	43	54	4.0	19.5
6PGU4-4375	Steel	43	75	4.0	19.5

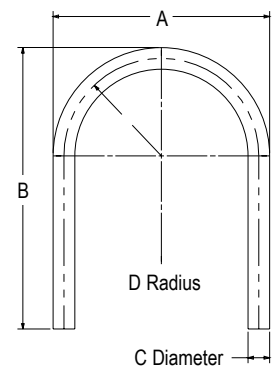

Half Circle Pipe Guards

# ONE SOURCE.

For the most innovative fueling solutions in the world, including conventional and vapor recovery hanging hardware and systems, tank gauges, fuel control systems, piping & containment and the industry's most complete line of 40 CFR-compliant underground tank equipment.



ABOVE GROUND PRODUCTS



BELOW GROUND PRODUCTS



ELECTRONIC FUEL MANAGEMENT PRODUCTS

## Solutions

To Keep Accurate Track of Your Valuable Fleet Fuel Assets 24/7/365

## Solutions

To Safely, Reliably & Efficiently Dispense Fuel & Keep Our Air Clean

## Solutions

To Recover Vapors, Control Tank Pressure and Fugitive Emissions to Keep Our Air Clean

## Solutions

To Safely & Efficiently Transfer Fuel; Contain Leak Hazards under Dispensers to Prevent Ground Contamination and Keep Our Water Pure

## Solutions

To Protect Customers and Dispenser Investments in the event of an Accidental Drive-Away

## Solutions

To Help Protect Customers and Property in the event of a Dispenser Dislodging

## Solutions

To Monitor Tank Levels, Inventories, Fuel Containment Integrity and Provide Notification of Leaks and Levels 24/7/365

## Solutions

To Prevent Environmental Contamination and Keep Our Water Pure

Leading The Way Since 1892